

# SCHEDA COMPONENTI PARTS LAYOUT ART. 4410

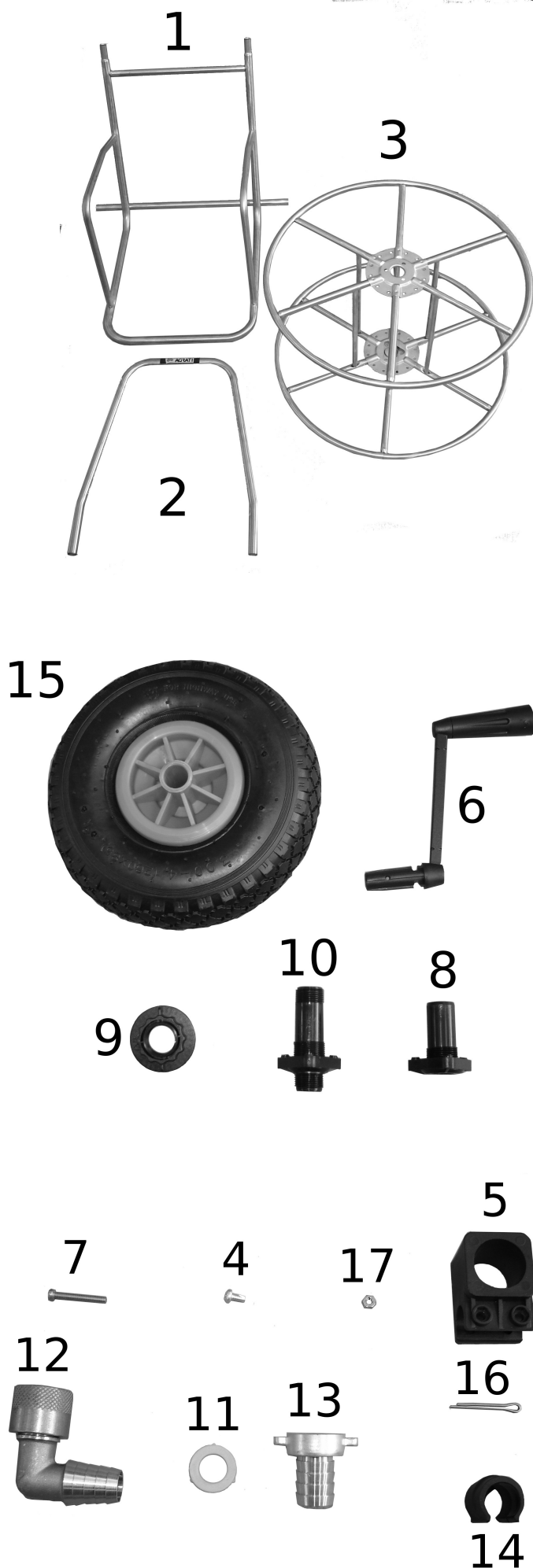

| Posizione<br>Position Nr. | Descrizione<br>Description   | Pezzi<br>Pieces |
|---------------------------|--|-----------------|
| 1                         | Telaio<br>Frame  | 1               |
| 2                         | Maniglia<br>Handle   | 1               |
| 3                         | Avvolgitubo<br>Hose reel   | 1               |
| 4                         | Vite automaschiante 4x8<br>Self-threading screw 4x8  | 2               |
| 5                         | Supporto<br>Mounting   | 2               |
| 6                         | Manovella<br>Crank   | 1               |
| 7                         | Vite 4 MA x 30 inox<br>4 MA x 30 stainless steel screw                                     | 4               |
| 8                         | Innesto manovella<br>Crank coupling  | 1               |
| 9                         | Controdado<br>Set screw  | 2               |
| 10                        | Raccordo di entrata<br>Entry socket  | 1               |
| 11                        | Guarnizione 3/4''<br>Gasket 3/4''  | 1               |
| 12                        | Raccordo curvo girevole 3/4'' in<br>ottone<br>Revolving curved fitting 3/4'' brass<br>made | 1               |
| 13                        | Portagomma con girello<br>19x3/4''+guarnizione<br>Hose holder 19x3/4''+gasket              | 1               |
| 14                        | Clip diam. 22<br>Plastic Feet  | 2               |
| 15                        | Ruota<br>Wheel   | 2               |
| 16                        | Copiglia 3x25 inox<br>Stopping pin 3x25 stainless steel                                    | 2               |
| 17                        | Dado 4 MA inox<br>4 MA stainless steel nut   | 4               |

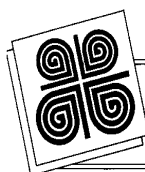

**AGRATI**



FABBRICA ARTICOLI PER IL GIARDINO  
FACTORY OF ARTICLES FOR THE GARDEN  
VIA STELVIO, 25 - 20010 VITUONE - (MI)  
TEL. 39-02-901.11.020 FAX 39-02-901.11.158  
INTERNET: WWW.AGRATI.NET  
E-MAIL: INFO@AGRATI.NET